

Case Study Amazon Fulfilment Distribution Centre Solution

Engineers at Amazon fulfilment centres are required to maintain material handling equipment, conveyors & packaging machinery to ensure their smooth running & full-time operation.

Awkward & restricted access areas present additional hazards when working at height. Maintenance tasks must routinely be performed where access is complicated & where standard working at-height equipment cannot fit.

Management at Amazon places the highest importance on providing fit-for-purpose, work-at-height safety equipment, on which staff have been professionally trained to assemble, inspect & use safely.

Access equipment that is unstable or rickety or does not fit properly & is, therefore, dangerous is not allowed on site. Giving engineers the best product to do the job also helps Amazon retain staff & reduce costs.

The LOBO Advanced Platform is the solution.

The LOBO System is a versatile work platform product that combines the flexibility & strength of traditional scaffolding with the simplicity & mobility of tower systems.

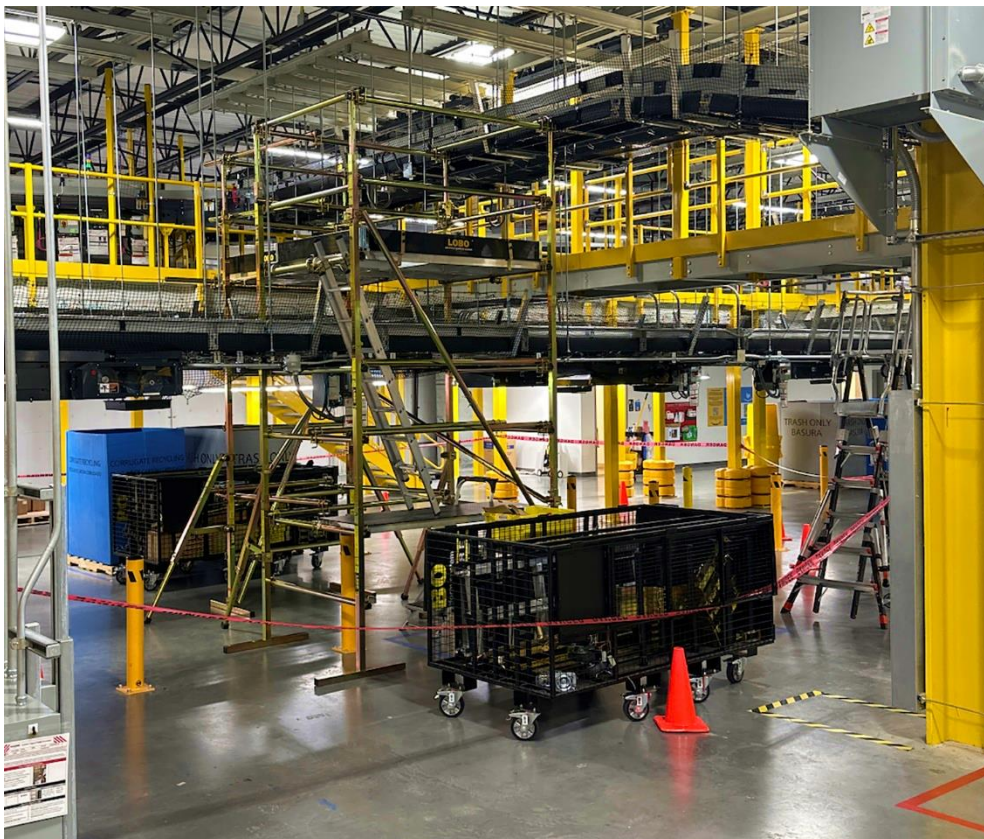

www.lobosystems.com

Conformities

EU: BS EN1004-1:2020 & EU: BS EN1004-2:2021 (BS 1139)

USA: OSHA CFR 29 1926 450-454 & subpart L & codified under 29 CFR 1910.27(a).

Canada: CSA Z797-18 and 269.2 -M87

Australia: AS/NZS 1576.1:2010 and AS/NZS 1576.3:2015 Tower

ISO 9001 : 2015
CERTIFIED 213858

When combined with the tube, the unique & patented hand-adjustable clamp allows the technician to create a work platform of any shape or size without needing any tools.



The system is made from modular steel components, which are easy & quick to assemble & provide a rock-solid & safe working platform. In addition, it flat packs for transportation & yet is solid. Areas previously awkward to get to can now be easily accessed by your engineers or technicians whenever required.

The LOBO System comprises trestle legs that vary in size & adjustable extensions with fixed side clamps. Steel tubes can then be passed through the clamps, which are hand tightened to form a structure to suit the application.

Sway braces, toe boards, wheels, guardrails, outriggers, & a LOBO Lifting Slider Beam can enhance the construction.

The LOBO System is scalable, adaptable & adjustable to meet your ongoing & changing requirements.

www.lobosystems.com

Conformities

EU: BS EN1004-1:2020 & EU: BS EN1004-2:2021 (BS 1139)

USA: OSHA CFR 29 1926 450-454 & subpart L & codified under 29 CFR 1910.27(a).

Canada: CSA Z797-18 and 269.2 -M87

Australia: AS/NZS 1576.1:2010 and AS/NZS 1576.3:2015 Tower

ISO 9001 : 2015
CERTIFIED 213858

Add more components or alter your existing configuration to satisfy the demands of the next task. Protect your initial investment with a product that will safely meet all your access needs.

LOBO Towerstore offers security on or off-site, providing a secure yet simple way to store & manage your LOBO components.

Explicitly designed for LOBO's advanced work platform system, it is fitted with feet for easy pallet truck or forklift manoeuvrability. Also, it can be locked with a padlock for security or storage. The Towerstore can be vertically or horizontally mounted to suit the workshop & transported for rapid deployment, on & off-site.

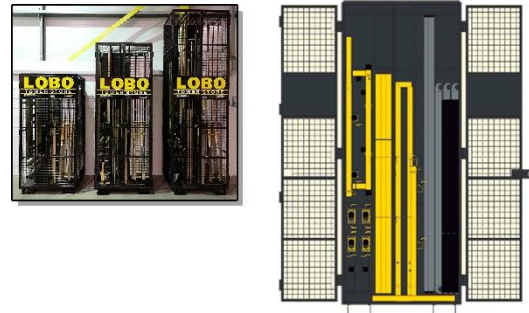

The LOBO System can be transported & assembled fast & easily from a flat pack, into any required configuration, by your maintenance engineers & technicians.

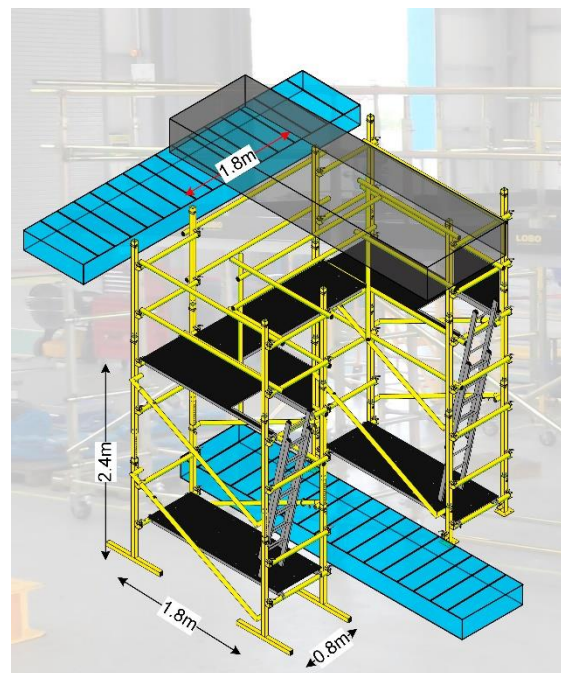
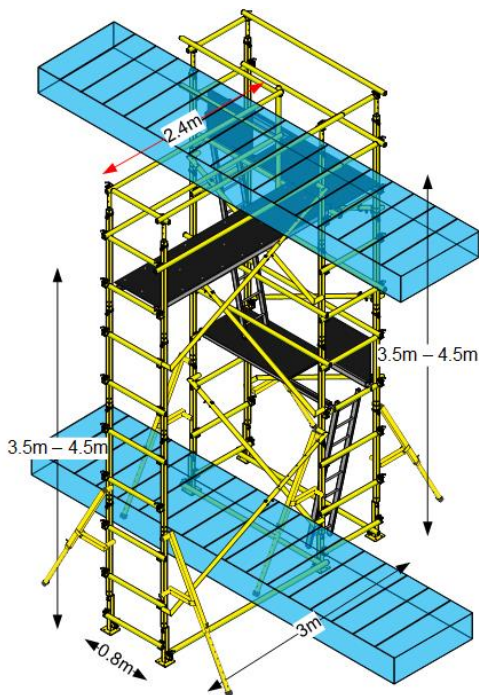

Options include Lifting Slider beams which can be fitted to the system. & it can be stored in a LOBO Towerstore unit when not in use.

LOBO is a rigid & stable product which meets or exceeds international safety regulations.

LOBO Systems provides fully certified training for safe assembly, inspection & use.

www.lobosystems.com

Conformities

EU: BS EN1004-1:2020 & EU: BS EN1004-2:2021 (BS 1139)

USA: OSHA CFR 29 1926 450-454 & subpart L & codified under 29 CFR 1910.27(a).

Canada: CSA Z797-18 and 269.2 -M87

Australia: AS/NZS 1576.1:2010 and AS/NZS 1576.3:2015 Tower

ISO 9001 : 2015
CERTIFIED 213858